



Municipality of West Elgin

Addendum Agenda

Council Meeting

Date: July 22 2021, 9:30 a.m.

Location: Electronic Participation Meeting via Zoom

Due to COVID-19 and physical distancing requirements this meeting is being held in an alternate location to allow the public to attend. Please contact the Clerk's Department if you require an alternate format or accessible communication support or wish to receive the link to the meeting, at 519-785-0560 or by email at clerk@westelgin.net.

Pages

8. Staff Reports

8.5. *M. Badura, CAO/Treasurer - Electronic Signs Purchase*

2

Recommendation:

That West Elgin Council hereby receives the report from M. Badura, CAO/Treasurer re: Electronic Signs, and

That West Elgin Council hereby approves the purchase of two electronic signs from _____ in the amount of \$ _____ plus applicable taxes.



Staff Report

Report To: Council Meeting
From: Magda Badura, CAO/Treasurer
Date: 2021-07-22
Subject: Electronic Signs Purchase

Recommendation:

That West Elgin Council hereby receives the report from M. Badura, CAO/Treasurer re: Electronic Signs, and

That West Elgin Council hereby approves the purchase of two electronic signs from _____ in the amount of \$ _____ plus applicable taxes.

Purpose:

During 2021 Budget deliberations council decided to allocate Ontario Invest Grant fund in the amount of \$82,000.00 for the purchase and installation of two electronic signs for both villages.

Recently the municipal staff prepared an RFP (Request for Proposal) and have reached out to seven business with deadline to respond by July 16, 2021.

Five proposals have been received by the Municipal staff as per table below.

Company Name	Price (before HST)
Steel Art Signs	\$ 83,416.60
Excellent Signs & Displays	\$ 114,700.00
Everest Signs	\$ 120,000.00
Zip Signs	\$ 141,224.00
Libertevision Inc.	\$ 140,654.49

All the proposals are recommending the monument signs, which are the most durable exterior signs. The monument signs are elegant and made of materials such as aluminum, bricks, sign foam and masonry like stones. Unfortunately, when we allocate the money we used the price of a pylon signs, similar to the Municipality of Dutton-Dunwich sign that can stand above on the tall poles and hold one large sign above in the air.

Out of five proposals three have been selected for Council's feedback and decision.

Option#1

Excellent Signs & Displays Inc. - \$114,700.00 plus HST – London Ontario

Price includes:

- Supply and installation of Two (2) double sided signs, illuminated ground sign

- Signs are fabricated of welded aluminum, mounted on internal steel supports with welded base plates.
- Illumination of sign consists of white low voltage LED's
- Village letters are individual freestanding reverse channel, with halo LED lighting
- Sub text lettering and logos are routed out of aluminum, with push through acrylics'
- Excavation, rebar, anchor bolts, and concrete for footings included
- Screen size 4'3" H x 7'4" W
- Includes software and training
- Includes wireless control
- 5 years warranty
- Engineering fees for sign structure are included
- Procurement of Municipal permit included – fees not included.

OPTION #2

Steel Art Signs – \$83,416.60 plus HST - Richmond Hill, Ontario

Price includes:

- Digital ground sign with 10 RGP EMC displays
- Header panel with alum cut out village name and lower panel motif with village logo.
- Wifi connection
- Site inspections, public and private locates, hydrovac concrete foundations, re-bar, anchor bolts, signage delivery to site, installation, final electrical connection and ESA inspections, testing, set up of software and training
- Screen Size 4'2" x 7'4"

OPTION #3

Everest Signs - \$120,000 plus HST – Toronto, Ontario

Price includes:

- Shop drawings, engineering, site meetings, sign foundation, main sign cost, LED screen, installation and commissioning.
- Both signs will be made up of aluminum, all weather outdoor material.
- LED Message Board will come with the operating system/software with capability of remote connection over cloud/internet based.
- All permanent name, logos, messages to be laser/waterjet cutoff out of aluminum faces.
- All sign cabinets to be internally illuminated with LED lights in colour controlled through a Dusk to Dawn photocell controller
- Sign to be CSA approved
- Screen size 8'4" x 3'1"
- LED screen include a large high resolution, P6 pixel pitch, 2560 mm outdoor video
- LED life 100,000 hours
- Staff training will be provided
- Project may take up to 16 weeks to complete.
- Five year warranty

Financial Implications:

If Council decides with the most expensive option Ontario Invest Grant will need to be revised to cover the additional cost as per below:

Transfer from Reserves - Ontario Invests - Improve Service Delivery & Efficiency		
Beg Balance - Jan 1, 2020	\$	553,560.00
Website Development	-	37,587.69
E-agenda Software	-	8,598.72
Balance at Dec 31, 2020		507,373.59
Strategic Planning		-
Asset Management Software & Training	-	250,000.00
Keyless Access Control & Electronic Time Keeper	-	20,000.00
Conferencing Equipment	-	30,000.00
Building Inspection Software	-	7,000.00
Laserfiche Software	-	10,000.00
Electronic Sign x 2	-	120,000.00
Water Modeling Study	-	40,000.00
Sanitary Sewer Capacity Report - West Lorne	-	30,000.00
IT Improvements - 2022		-
Balance at Dec 31, 2021	\$	373.59

Policies/Legislation:

Report Approval Details

Document Title:	Electronic Signs - 2021-31-Administration Finance.docx
Attachments:	<ul style="list-style-type: none">- Excellent Signs 1.pdf- Excellent Signs 2.pdf- Excellent Signs 3.pdf- Excellent Signs 4.pdf- Steel Art Sign.pdf- Everest Sign.pdf
Final Approval Date:	Jul 20, 2021

This report and all of its attachments were approved and signed as outlined below:

Jana Nethercott

ALL COLOURS TO BE CONFIRMED
WELDED ALUMINUM CONSTRUCTION

BASE DETAILS

[2] 6" X 6" X 1/4" OR [2] 5" X 5" X 1/4" THK STEEL H.S.S.
[2] 14" X 14" X 1" THK STEEL PLATES
[2] 1" DIAMETER X 3'-0" LG ANCHOR BOLTS (QTY: 4 PER)
[2] 24" DIAMETER X 5'-0" DEPTH CONCRETE FOOTING (AUGERED)
[1] 2" DIAMETER PVC PIPE ELECTRICAL CONDUIT ONE SIDE
15M AND 10M STEEL REINFORCEMENT BARS

FRONT VIEW (SIDE ONE)

END VIEW

FRONT VIEW (SIDE TWO)



SIGN TYPE: **D/S ILLUMINATED GATEWAY MONUMENT SIGNS - PROPOSAL "A"**

CUSTOMER: MUNICIPALITY OF WEST ELGIN

ADDRESS: FURNIVAL ROAD,
RODNEY, ONTARIO

W.O. #

DESIGN NO. **H283 SK05 - pg.1**

SCALE: 3/8" = 1'-0"

APPROVED BY CUSTOMER:

DESIGN DATE: JULY 13 / 2021

REVISION #1:

DATE:

ACC. EXEC.: MIKE VAN ESCH

DESIGNER: BOB DARNELL

2736 DINGMAN DRIVE, LONDON, ON
519-681-5492 excellentsigns.com

50
YEARS



excellent

SIGNS & DISPLAYS inc.

2736 DINGMAN DRIVE, LONDON, ON
519-681-5492 excellentsigns.com

50
YEARS

SIGN TYPE: D/S ILLUMINATED GATEWAY MONUMENT SIGNS - PROPOSAL "A"			DESIGN NO. H283 SK05 - pg.2	DESIGN DATE: JULY 13 / 2021
CUSTOMER: MUNICIPALITY OF WEST ELGIN			SCALE: NOT TO SCALE	REVISION #1:
ADDRESS: FURNIVAL ROAD, RODNEY, ONTARIO			APPROVED BY CUSTOMER:	DATE:
W.O. #			ACC. EXEC.: MIKE VAN ESCH	
			DESIGNER: BOB DARNELL	
ALL ARTWORK REMAINS THE PROPERTY OF EXCELLENT SIGNS & DISPLAYS INC.				



SIGN TYPE: D/S ILLUMINATED GATEWAY MONUMENT SIGNS - PROPOSAL "A"	
CUSTOMER: MUNICIPALITY OF WEST ELGIN	
ADDRESS: FURNIVAL ROAD, RODNEY, ONTARIO	ACC. EXEC.: MIKE VAN ESCH
W.O. #	DESIGNER: BOB DARNELL

DESIGN NO. H283 SK05 - pg.3	DESIGN DATE: JULY 13 / 2021
SCALE: NOT TO SCALE	REVISION #1:
APPROVED BY CUSTOMER:	DATE:
ALL ARTWORK REMAINS THE PROPERTY OF EXCELLENT SIGNS & DISPLAYS INC.	

PROPOSAL B

- A** 30" DEEP ALUMINUM FABRICATED TOP CAP / PAINTED TO MATCH 3M 3630-126 DARK EMERALD GREEN
- B** 22" DEEP ALUMINUM FABRICATED SIGN CABINET / ALUMINUM FACE AND RETURNS PAINTED WHITE / ROUTERED OUT OUTER LOGO SHAPE AND "VILLAGE OF" COPY TO HAVE WHITE ACRYLIC PUSHING THROUGH FACE 1/2" / 3M 3630-131 GOLD METALLIC, 3M 3630-126 DARK EMERALD GREEN AND 3M 3630-128 PLUM PURPLE VINYL APPLIED TO THE FACE OF LOGO AND 3M 3630-51 SILVER GRAY VINYL APPLIED TO THE FACES OF "VILLAGE OF" COPY (EDGES REMAIN WHITE) / ILLUMINATED WITH WHITE LEDS
- C** 2" DEEP ALUMINUM FABRICATED REVERSE CHANNEL LETTERS / PAINTED TO MATCH 3M 3630-126 DARK EMERALD GREEN / MOUNTED TO ALUMINUM FACE ON 2" STANDOFFS / 3/16" WHITE LEXAN BACKS / HALO-ILLUMINATED WITH WHITE LEDS
- D** 2" WIDE ALUMINUM FABRICATED REVEALS AROUND SIGN CABINET AND ENCLOSURE / PAINTED WHITE

- E** GREENTAK GSH OUTDOOR FULL COLOUR LED ELECTRONIC MESSAGE CENTRES / 10MM PITCH / 96 X 320 PIXELS / MOUNTED TO EACH SIDE OF 12" DEEP ALUMINUM FABRICATED ENCLOSURE / ENCLOSURE FACE AND RETURNS PAINTED WHITE
- F** 12" DIAMETER ALUMINUM FABRICATED POLE ENCLOSURES / PAINTED WHITE
- G** 18" DIAMETER ALUMINUM FABRICATED BASE PLATE ENCLOSURES / PAINTED TO MATCH 3M 3630-126 DARK EMERALD GREEN
- H** [2] 6" X 6" X 1/4" OR [2] 4" X 8" X 1/4" THK STEEL H.S.S.
[2] 14" X 14" X 1" THK STEEL PLATES
[2] 1" DIAMETER X 3'-0" LG ANCHOR BOLTS (QTY: 4 PER)
[2] 24" DIAMETER X 5'-0" DEPTH RAISED CONCRETE FOOTING (AUGERED)
[1] 2" DIAMETER PVC PIPE ELECTRICAL CONDUIT ONE SIDE
15M AND 10M STEEL REINFORCEMENT BARS

ALL COLOURS TO BE CONFIRMED
WELDED ALUMINUM CONSTRUCTION

FRONT VIEW (SIDE ONE)

END VIEW

FRONT VIEW (SIDE TWO)

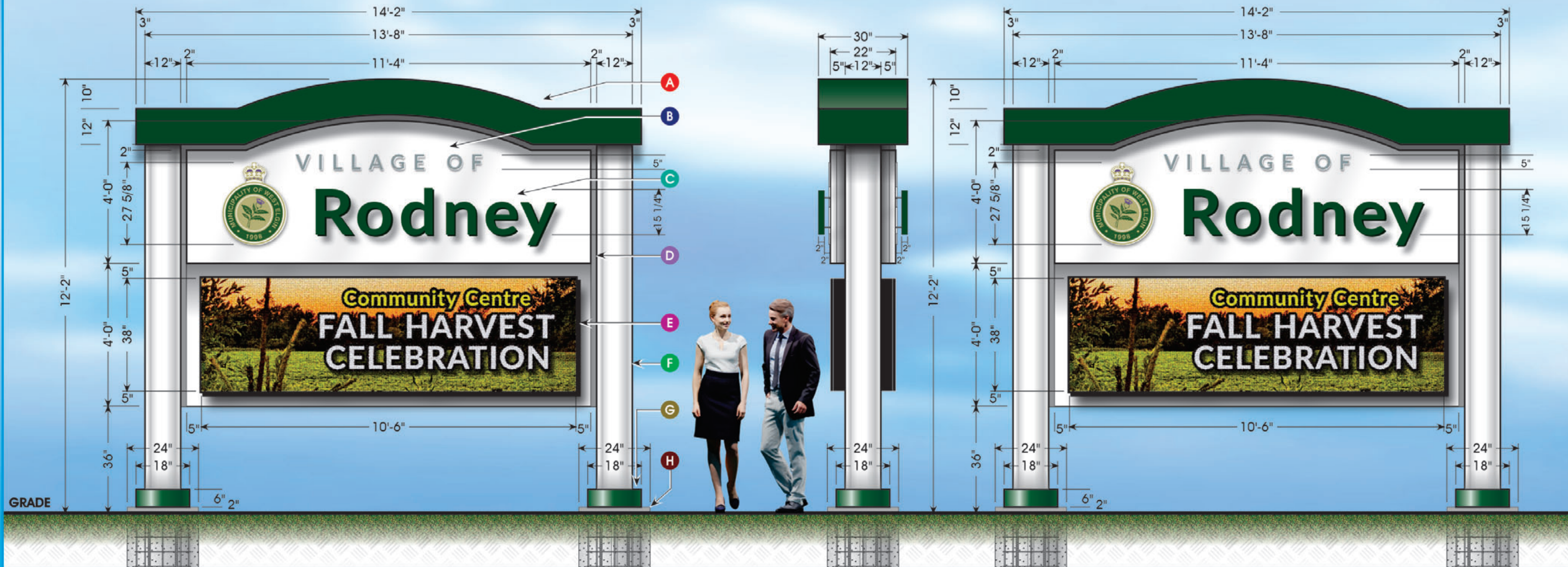

2736 DINGMAN DRIVE, LONDON, ON
519-681-5492 excellentsigns.com

50
YEARS

SIGN TYPE: **D/S ILLUMINATED GATEWAY MONUMENT SIGN - PROPOSAL "B"**

CUSTOMER: MUNICIPALITY OF WEST ELGIN

ADDRESS: FURNIVAL ROAD,
RODNEY, ONTARIO

W.O. #

DESIGN NO. **H283 SK06 - pg.1**

SCALE: 3/8" = 1'-0"

APPROVED BY CUSTOMER:

DESIGN DATE: JULY 13 / 2021

REVISION #1:

DATE: / /

ACC. EXEC.: MIKE VAN ESCH

DESIGNER: BOB DARNELL

ALL ARTWORK REMAINS THE PROPERTY OF EXCELLENT SIGNS & DISPLAYS INC.



excellent

SIGNS & DISPLAYS inc.

2736 DINGMAN DRIVE, LONDON, ON
519-681-5492 excellentsigns.com

50
YEARS

SIGN TYPE:	D/S ILLUMINATED GATEWAY MONUMENT SIGN - PROPOSAL "B"		
CUSTOMER:	MUNICIPALITY OF WEST ELGIN		
ADDRESS:	FURNIVAL ROAD, RODNEY, ONTARIO		
W.O. #			
	ACC. EXEC.:	MIKE VAN ESCH	
	DESIGNER:	BOB DARNELL	

DESIGN NO.	H283 SK06 - pg.2	DESIGN DATE:	JULY 13 / 2021
SCALE:	NOT TO SCALE	REVISION #1:	
APPROVED BY CUSTOMER:	DATE:		
ALL ARTWORK REMAINS THE PROPERTY OF EXCELLENT SIGNS & DISPLAYS INC.			

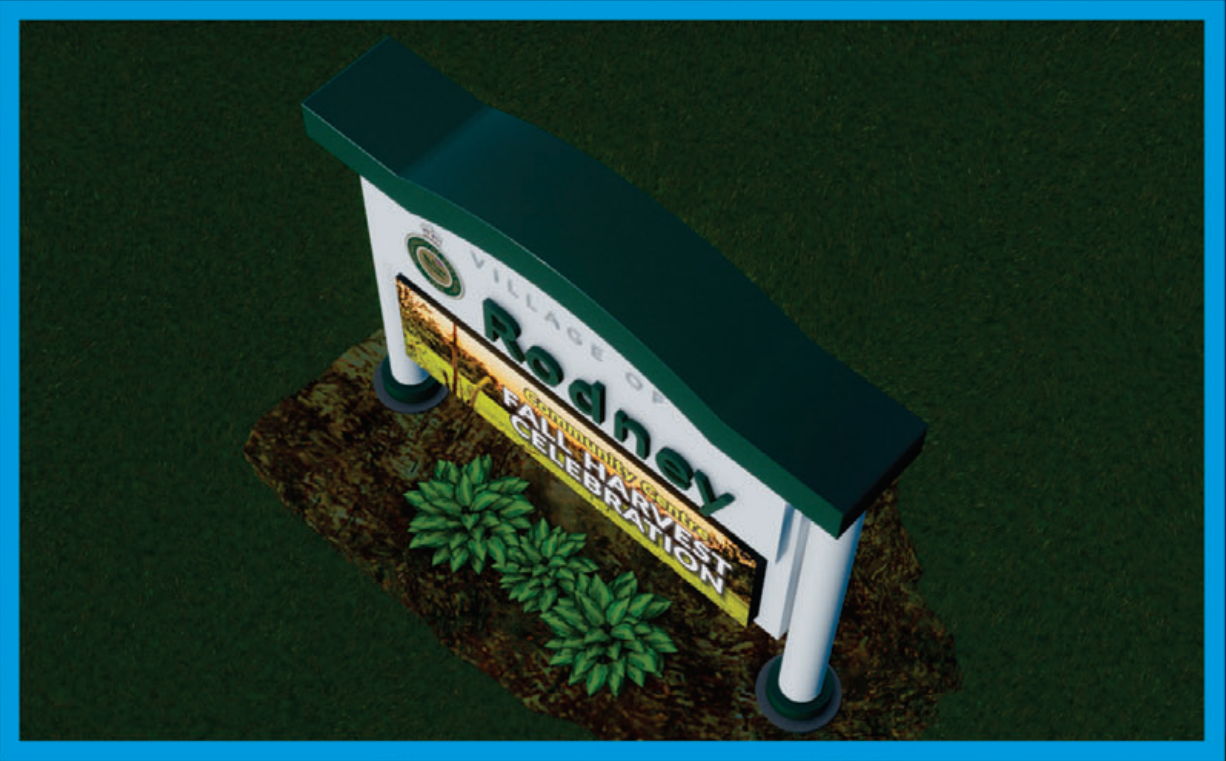
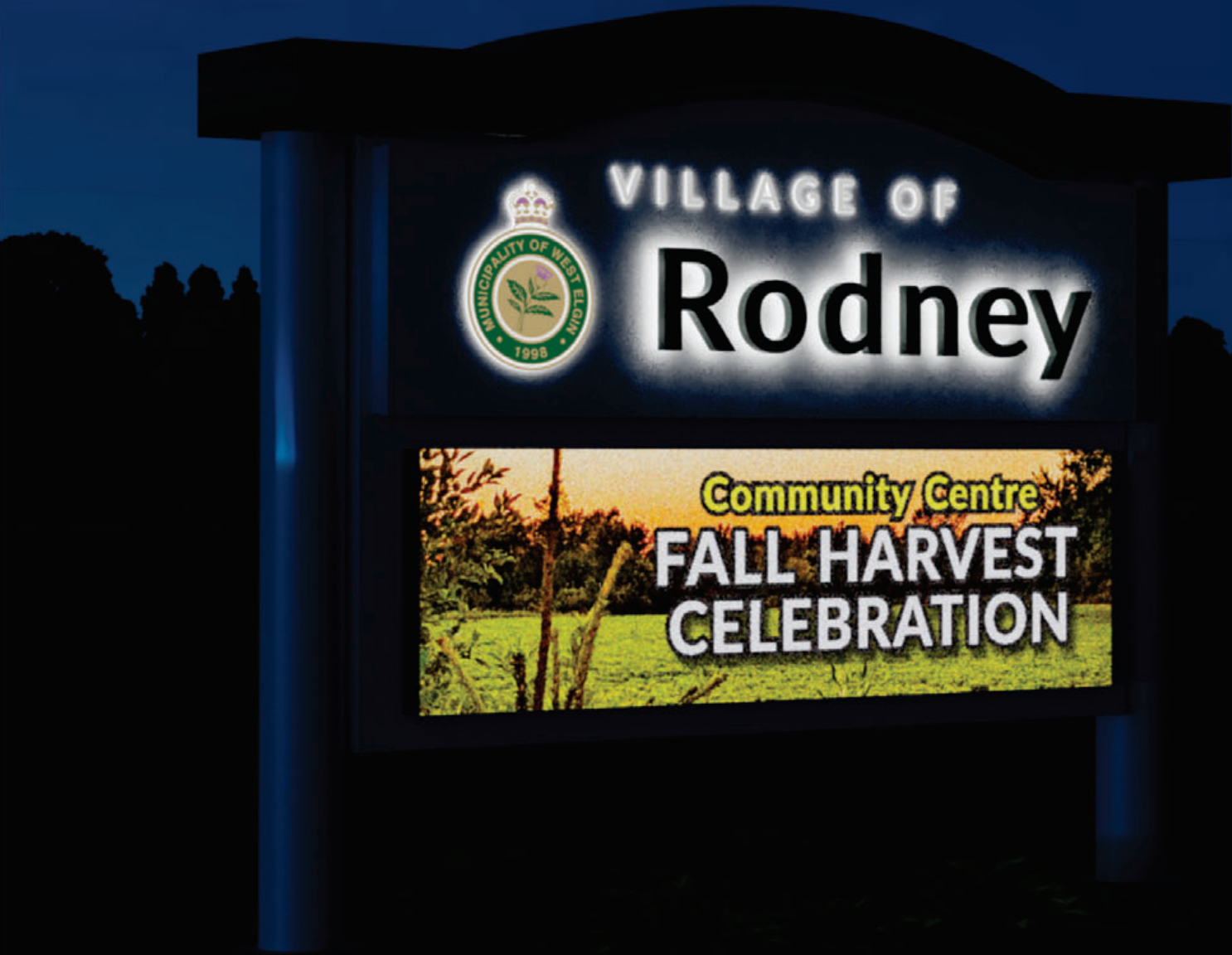

ALL COLOURS TO BE CONFIRMED
WELDED ALUMINUM CONSTRUCTION

BASE DETAILS

[2] 6" X 6" X 1/4" OR [2] 5" X 5" X 1/4" THK STEEL H.S.S.
[2] 14" X 14" X 1" THK STEEL PLATES
[2] 1" DIAMETER X 3'-0" LG ANCHOR BOLTS (QTY: 4 PER)
[2] 24" DIAMETER X 5'-0" DEPTH CONCRETE FOOTING (ALGERED)
[1] 2" DIAMETER PVC PIPE ELECTRICAL CONDUIT ONE SIDE
15M AND 10M STEEL REINFORCEMENT BARS

FRONT VIEW (SIDE ONE)

END VIEW

FRONT VIEW (SIDE TWO)

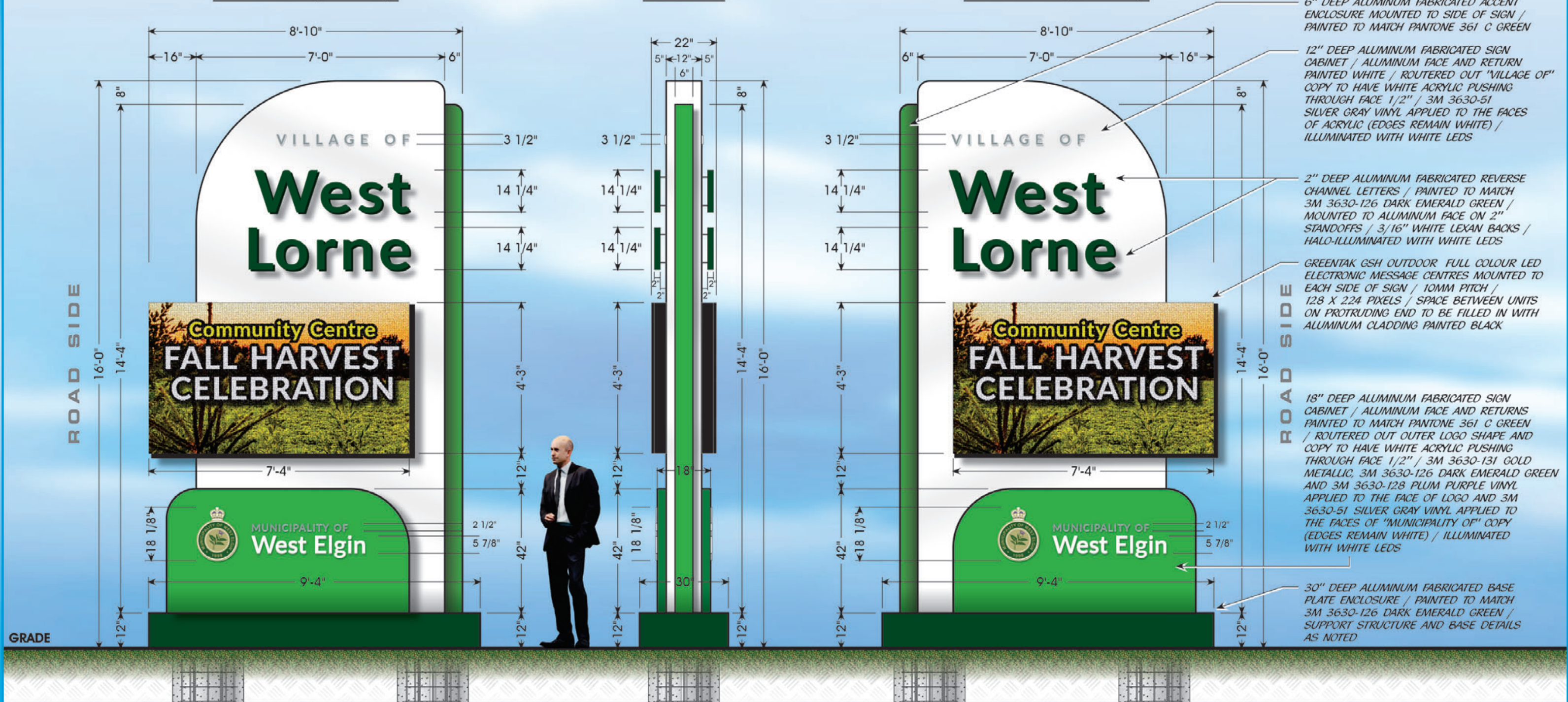

SIGN TYPE: **D/S ILLUMINATED GATEWAY MONUMENT SIGNS - PROPOSAL "A"**

CUSTOMER: MUNICIPALITY OF WEST ELGIN

ADDRESS: GRAHAM ROAD,
WEST LORNE, ONTARIO

W.O. #

DESIGN NO. **H283 SK07 - pg.1**

SCALE: 3/8" = 1'-0"

APPROVED BY CUSTOMER:

DESIGN DATE: JULY 13 / 2021

REVISION #1:

DATE: _____

ACC. EXEC.: MIKE VAN ESCH

DESIGNER: BOB DARNELL

ALL ARTWORK REMAINS THE PROPERTY OF EXCELLENT SIGNS & DISPLAYS INC.

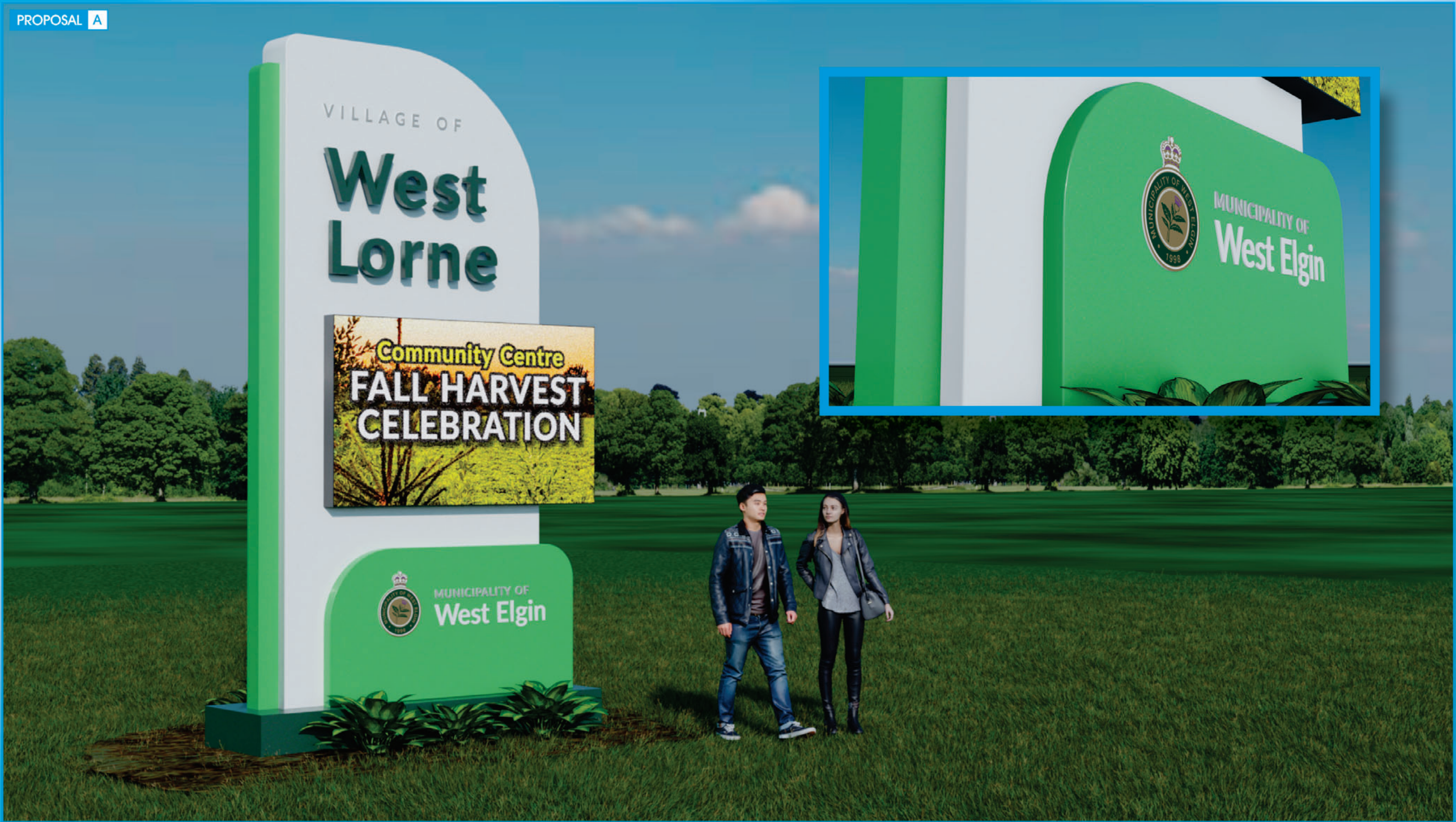

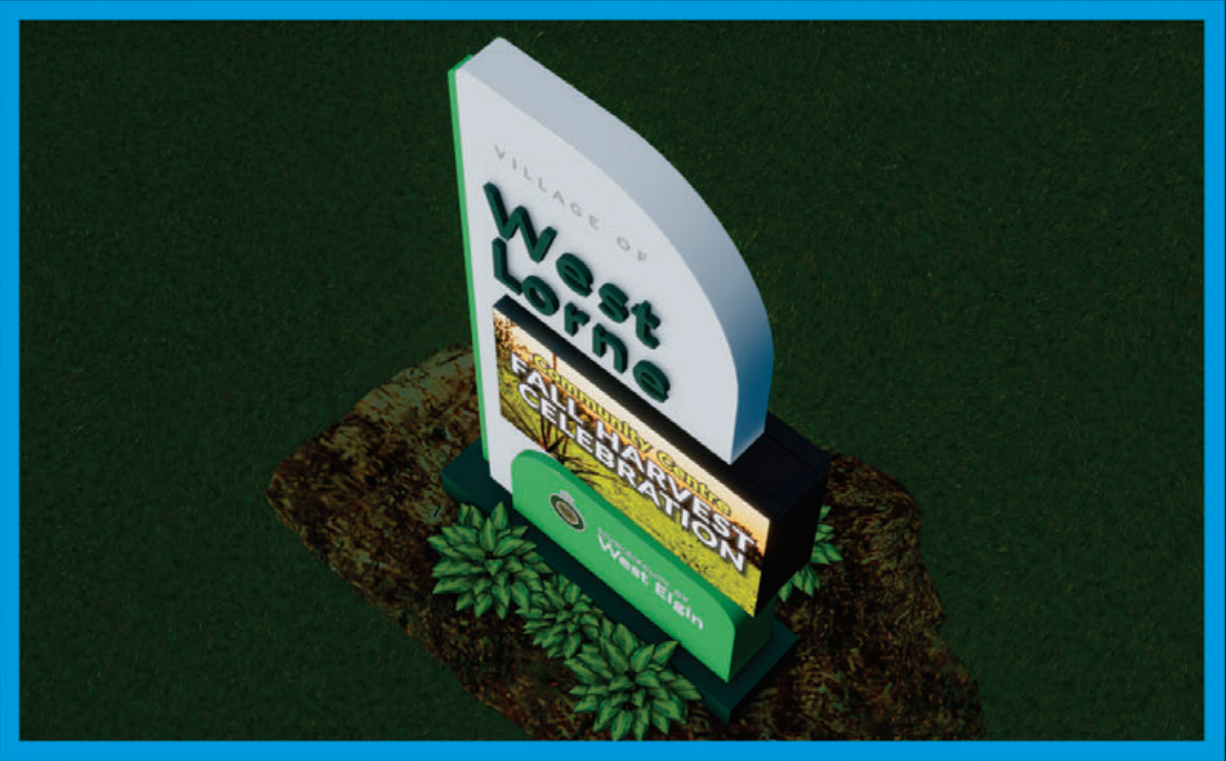

PROPOSAL B

- A** 30" DEEP ALUMINUM FABRICATED TOP CAP / PAINTED TO MATCH 3M 3630-126 DARK EMERALD GREEN
- B** 22" DEEP ALUMINUM FABRICATED SIGN CABINET / ALUMINUM FACE AND RETURNS PAINTED WHITE / ROUTERED OUT OUTER LOGO SHAPE AND "VILLAGE OF" COPY TO HAVE WHITE ACRYLIC PUSHING THROUGH FACE 1/2" / 3M 3630-131 GOLD METALLIC, 3M 3630-126 DARK EMERALD GREEN AND 3M 3630-128 PLUM PURPLE VINYL APPLIED TO THE FACE OF LOGO AND 3M 3630-51 SILVER GRAY VINYL APPLIED TO THE FACES OF "VILLAGE OF" COPY (EDGES REMAIN WHITE) / ILLUMINATED WITH WHITE LEDS
- C** 2" DEEP ALUMINUM FABRICATED REVERSE CHANNEL LETTERS / PAINTED TO MATCH 3M 3630-126 DARK EMERALD GREEN / MOUNTED TO ALUMINUM FACE ON 2" STANDOFFS / 3/16" WHITE LEXAN BACKS / HALO-ILLUMINATED WITH WHITE LEDS
- D** 2" WIDE ALUMINUM FABRICATED REVEALS AROUND SIGN CABINET AND ENCLOSURE / PAINTED WHITE

- E** GREENTAK GSH OUTDOOR FULL COLOUR LED ELECTRONIC MESSAGE CENTRES / 10MM PITCH / 96 X 320 PIXELS / MOUNTED TO EACH SIDE OF 12" DEEP ALUMINUM FABRICATED ENCLOSURE / ENCLOSURE FACE AND RETURNS PAINTED WHITE
- F** 12" DIAMETER ALUMINUM FABRICATED POLE ENCLOSURES / PAINTED WHITE
- G** 18" DIAMETER ALUMINUM FABRICATED BASE PLATE ENCLOSURES / PAINTED TO MATCH 3M 3630-126 DARK EMERALD GREEN
- H** [2] 6" X 6" X 1/4" OR [2] 4" X 8" X 1/4" THK STEEL H.S.S.
[2] 14" X 14" X 1" THK STEEL PLATES
[2] 1" DIAMETER X 3'-0" LG ANCHOR BOLTS (QTY: 4 PER)
[2] 24" DIAMETER X 5'-0" DEPTH RAISED CONCRETE FOOTING (AUGERED)
[1] 2" DIAMETER PVC PIPE ELECTRICAL CONDUIT ONE SIDE
15M AND 10M STEEL REINFORCEMENT BARS

ALL COLOURS TO BE CONFIRMED
WELDED ALUMINUM CONSTRUCTION

FRONT VIEW (SIDE ONE)

END VIEW

FRONT VIEW (SIDE TWO)

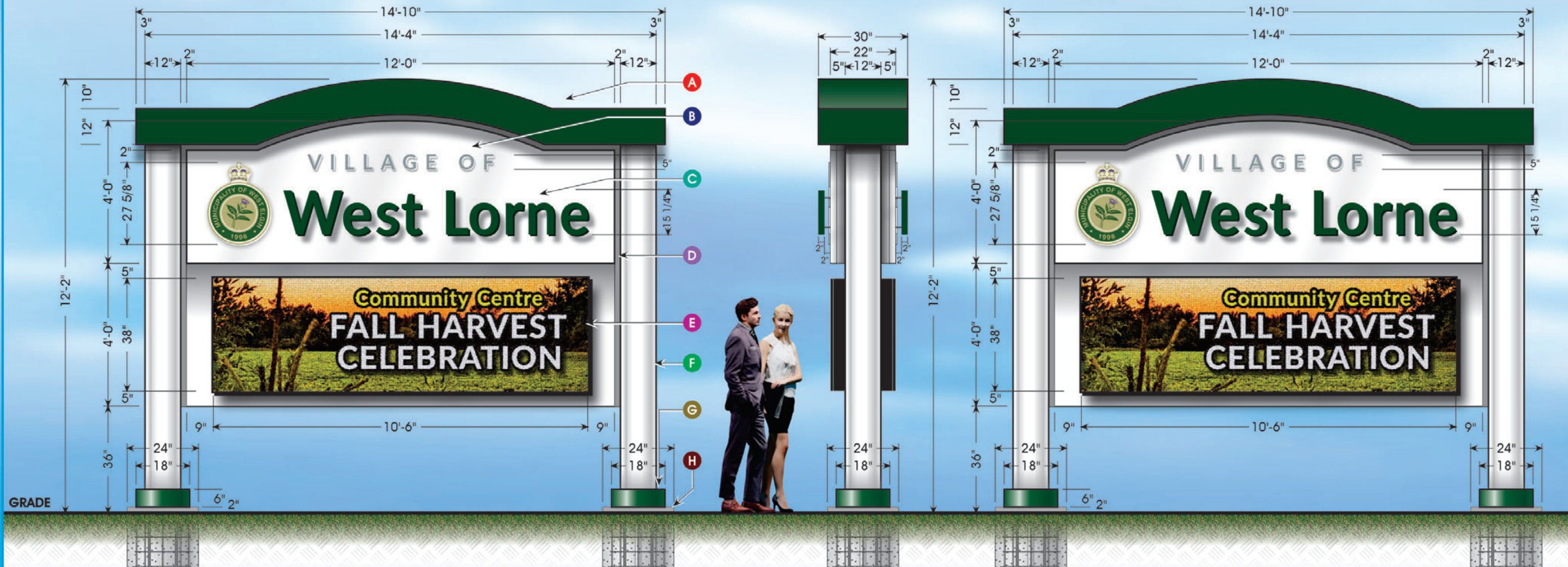

SIGN TYPE: **D/S ILLUMINATED GATEWAY MONUMENT SIGN - PROPOSAL "B"**

CUSTOMER: MUNICIPALITY OF WEST ELGIN

ADDRESS: GRAHAM ROAD,
WEST LORNE, ONTARIO

W.O. #

DESIGN NO. **H283 SK08 - pg.1**

SCALE: 3/8" = 1'-0"

APPROVED BY CUSTOMER:

DESIGN DATE: JULY 13 / 2021

REVISION #1:

DATE: / /

ACC. EXEC.: MIKE VAN ESCH

DESIGNER: BOB DARNELL



excellent

SIGNS & DISPLAYS inc.

2736 DINGMAN DRIVE, LONDON, ON
519-681-5492 excellentsigns.com

50
YEARS

SIGN TYPE:	D/S ILLUMINATED GATEWAY MONUMENT SIGN - PROPOSAL "B"		
CUSTOMER:	MUNICIPALITY OF WEST ELGIN		
ADDRESS:	GRAHAM ROAD, WEST LORNE, ONTARIO	ACC. EXEC.:	MIKE VAN ESCH
W.O. #		DESIGNER:	BOB DARNELL

DESIGN NO.	H283 SK08 - pg.2	DESIGN DATE:	JULY 13 / 2021
SCALE:	NOT TO SCALE	REVISION #1:	
APPROVED BY CUSTOMER:	DATE:		

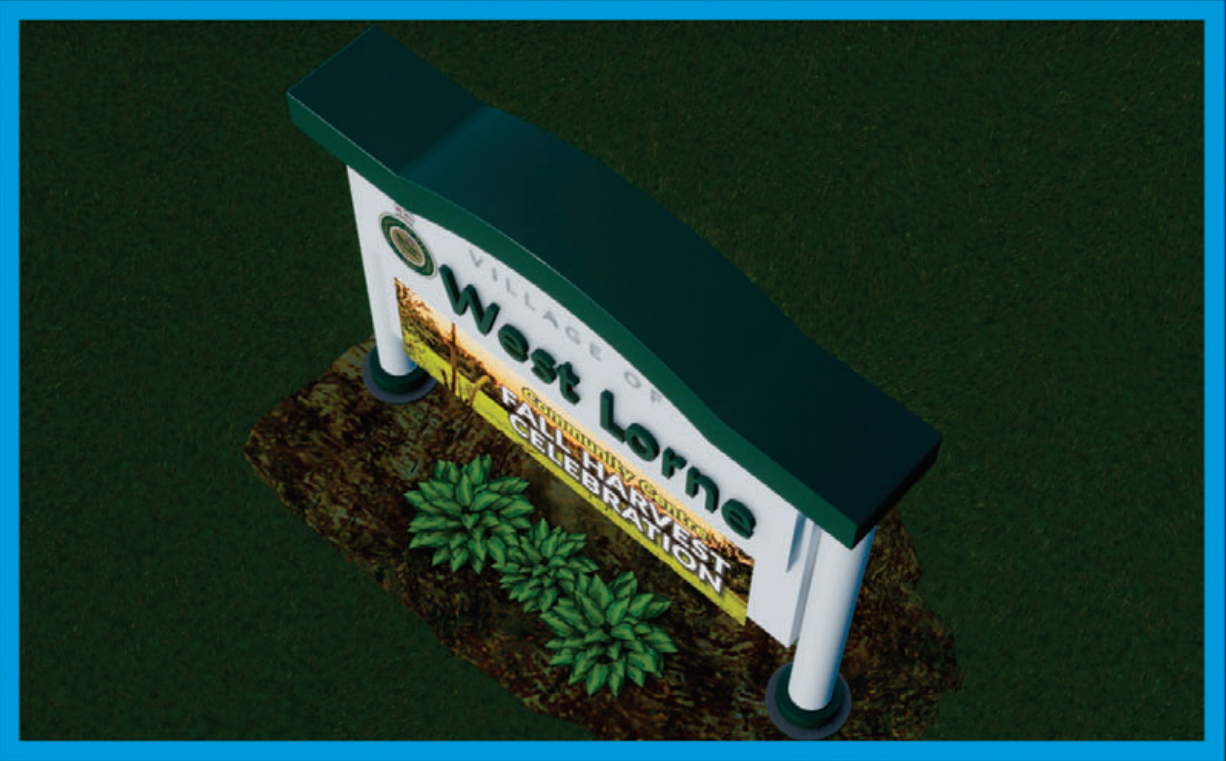



50

YEARS

2736 DINGMAN DRIVE, LONDON, ON
519-681-5492 excellentsigns.com

SIGN TYPE: D/S ILLUMINATED GATEWAY MONUMENT SIGN - PROPOSAL "B"	
CUSTOMER: MUNICIPALITY OF WEST ELGIN	
ADDRESS: GRAHAM ROAD, WEST LORNE, ONTARIO	ACC. EXEC.: MIKE VAN ESCH
W.O. #	DESIGNER: BOB DARNELL

DESIGN NO. H283 SK08 - pg.3	DESIGN DATE: JULY 13 / 2021
SCALE: NOT TO SCALE	REVISION #1:
APPROVED BY CUSTOMER:	DATE:
ALL ARTWORK REMAINS THE PROPERTY OF EXCELLENT SIGNS & DISPLAYS INC.	

Digital Village Signs

West Elgin

Village of Rodney
Village of West Lorne

Digital Signage

Scale	Date
as noted	07.09.2021
Drawn	Approved
JC	/
Drawing No.	Revision
JC21137 - Mockup	1

Revision Notes		
No.	Description	Date

Approvals:

x:

Approved By:

x:

Date:

COLOURS / FINISHES
PAINT

TO MATCH PMS 1817C

TO MATCH PMS 7509C

WHITE

ALL COLOURS/GRAPHICS
TO BE APPROVED OR
PROVIDED BY CLIENT

*** SITE CHECK REQUIRED

Copyright

All rights reserved, including the right to
reproduce in whole or in part without the
consent of Steel Art Signs Corp.

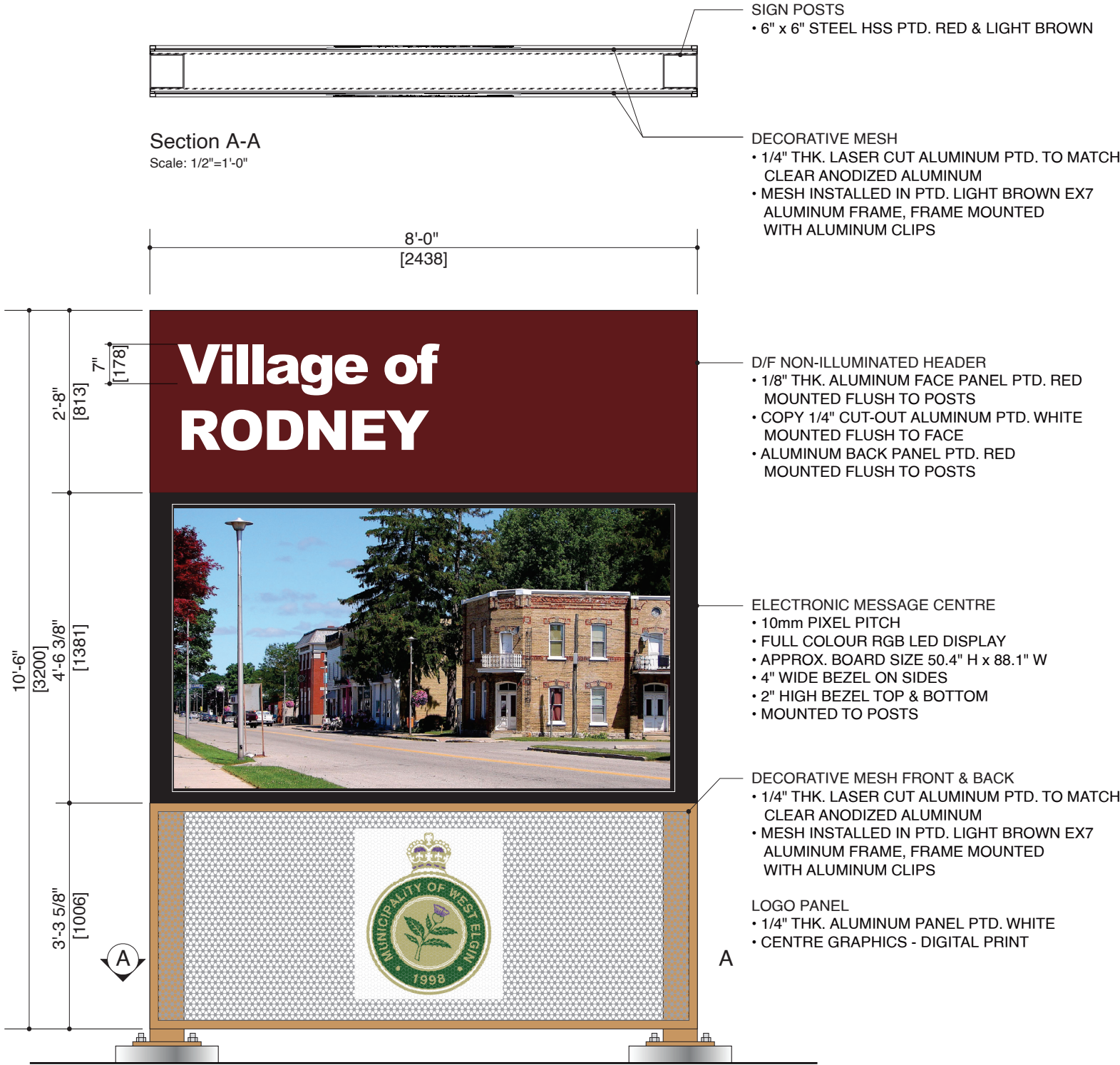

Typ. Graphics Layout - D/F Ground Sign
Scale: 1/2"=1'-0"

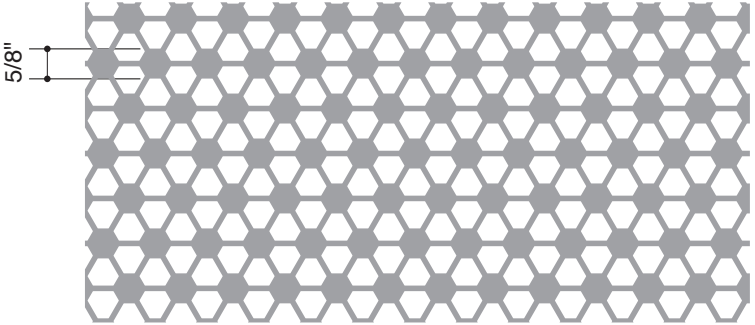

Mesh Pattern Detail
Scale 1:4

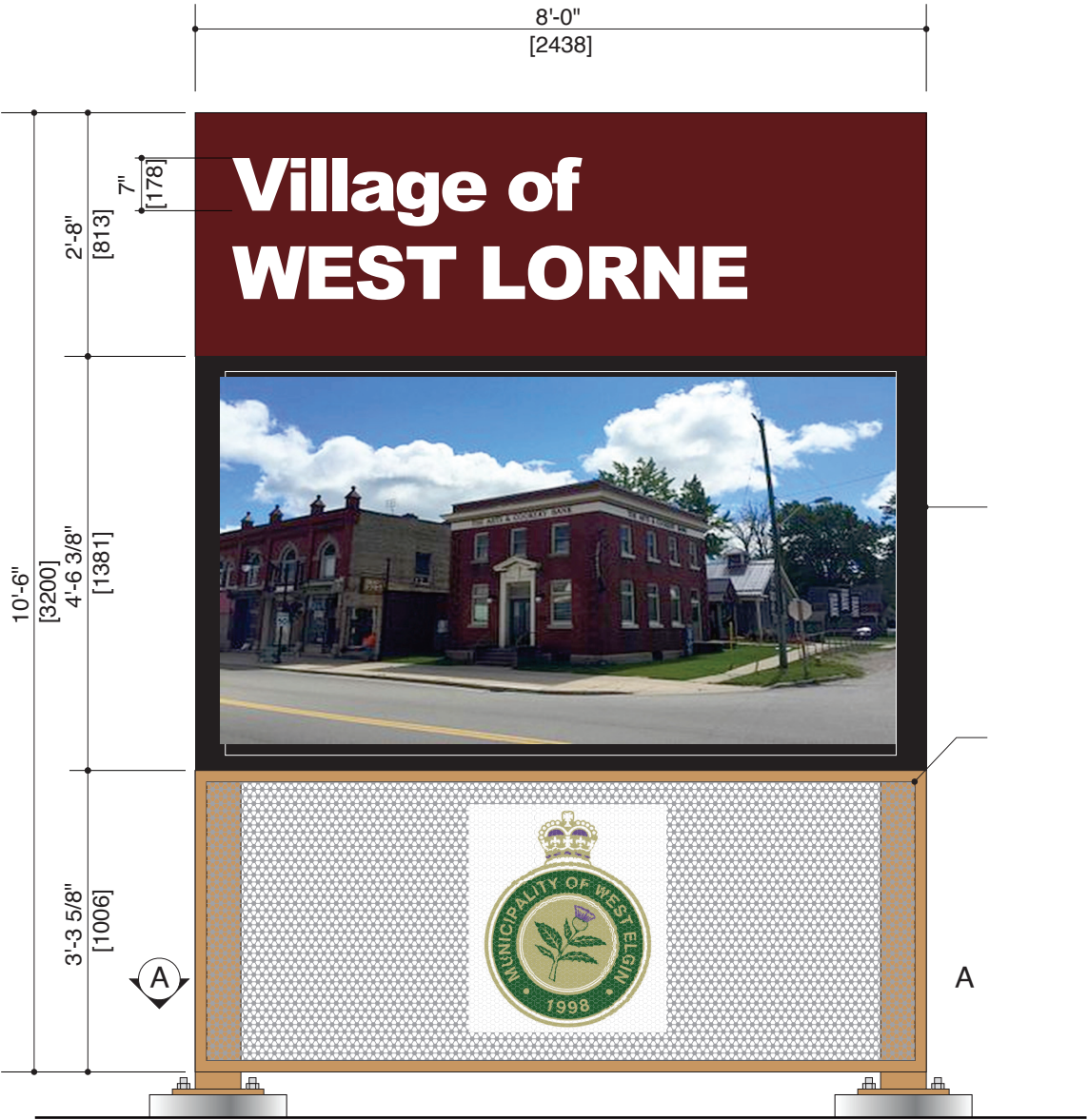

Typ. Graphics Layout - D/F Ground Sign
Scale: 1/2"=1'-0"



BACK

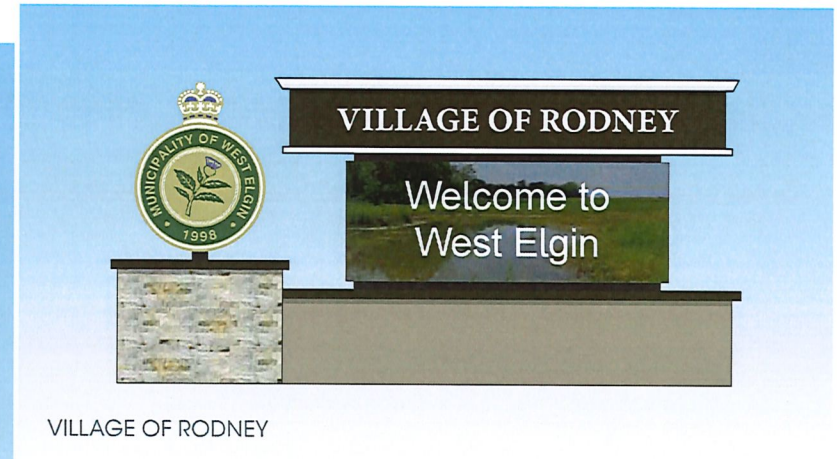

VILLAGE OF RODNEY



DESIGN - B
DOUBLE SIDED GROUND SIGN

**EVEREST
SIGNS**

CLIENT	LOCATION	PROJECT	QTY	FILE NAME	ORIGINAL DATE
Municipality of West Elgin	Village of West Lorne & Village of Rodney	Ground sign	--	West Elgin Monument Ground sign.ai	July 7, 2021
SALES - SG DRAWN BY -YIU L SCALE - NOT TO SCALE					REVISION DATE & #

SIGNATURE
APPROVED AS PER LAYOUT ABOVE. EVEREST SIGNS WILL NOT PROCEED WITH PRODUCTION WITH OUT YOUR SIGNATURE